

If your chart looks like the above, you are ready to move to the next step, which is to perform a Voltage Logging Data Run.

Click on the Checklist Form tab and take a look at this worksheet. You should print out a copy of this, take it to the production floor and note any last minute variations from how you planned to position all the sensors.

First Run

1. Charge the battery at least until the Amber LED is no longer flashing.
2. Create a fresh TruIDL DashBoard file and make a configuration with Sample rate of 0.25 (sec) and a Smoothing # = 1 (no smoothing) & upload the new TRUIDL.TXT file to the TruIDL device attached to your PC.
3. Print out a copy of the Checklist Form and take it with you to the ware.
4. Stop the conveyor line and install the sensors and double-check the location of each sensor
5. Stop the conveyor when the ware has left the last rinse stage & place logger in bucket of DI water.
6. Clean the Logger and put all the excess wire back onto the spools.
7. Measure the E-coat film thickness underneath each sensor tip and record to the Checklist Form and Dashboard too.
8. Download the TRUIDL.TXT file back to your c:\TruIDL folder and click 'Import Data from Run' on the View Results worksheet.
9. Save the file to your backup location and move a copy to your company network Drive or TruIDL Cloud Service.

Cleaning the Unit after a Run

Put the Module and Harness in a 20 l (5 gal) bucket filled with DI water after its removal from the ware. Use only isopropyl alcohol to clean the plastic and epoxy portions of the Module/Harness. Clean the grounding clamps, brass sensor tips, and magnet surfaces with the plastic bristle brush provided.

TruIDL-Components

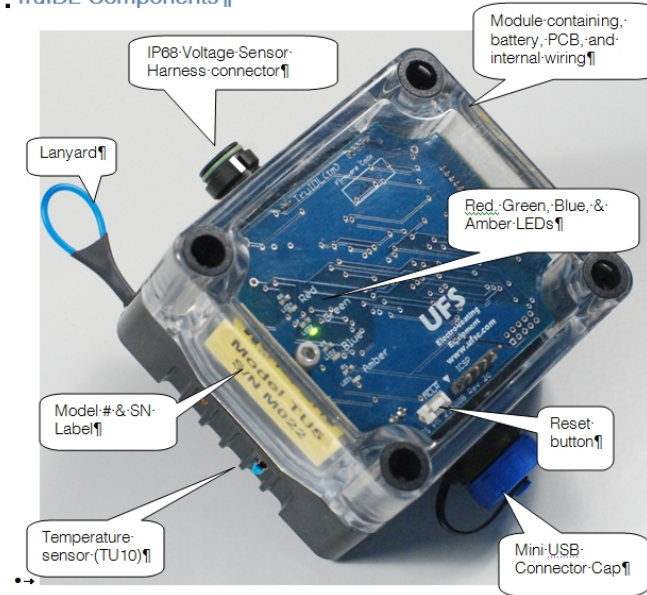

www.TruIDL.com (Jan 2012)

This will be the website dedicated for users of the TruIDL Logger. It will have a forum, wiki-like features for help and assistance, application notes, & trouble shooting. Also coming is a private TruIDL Cloud Service for customers to log on, upload data, retrieve old data runs, and compare results.

UFS Corporation

330 N 400 East
Valparaiso, Indiana 46383 USA

Tel +1 (219) 464-2027
Fax: +1 (219) 464-8646
E-mail: info@ufsc.com
www.ufsc.com & www.TruIDL.com



TruIDL™ Logger Quick Reference



Included in the carrying case are: 9 V battery, Battery test leads, Mini USB retract cable, USB Memory Stick, TruIDL Logger Module, Voltage Sensor Harness, syringe with 100% petroleum jelly, and this plastic coated reference card.

Keys to Success

- Charge the battery first via USB cable
- Clean the sensor tips
- Use 0.25 Sample rate & Smoothing = 1
- Keep sensor wires untangled by using the wire spools with each sensor
- Remove the TruIDL Logger & Harness before the curing ovens!
- Clean up only with isopropyl alcohol
- Use a camera to document the Run

Voltage Sensor Quick Identification Colors:



Charging the battery

Unless the unit was used in the past 5 days, the battery voltage will be too low to wake up. Unscrew the blue cap covering the Mini USB connector. Take the Mini USB cable and connect it to the unit and then your PC.

The Red & Green LEDs should be On. The Amber LED will have a slow flash and the Blue LED may be On or Off. (Photo 1).

After 30 minutes or so the Amber LED will stop blinking, which means the voltage is above the Low Level.

After the battery is fully charged, the Red LED will be off and just the Green LED on (Photo 2).

Note - your Blue LED maybe On, which indicates it has a fresh configuration file.

If you remove the USB cable from the TruIDL Logger, it will then go to sleep at the Shutdown timer value, unless there has been some activity: another USB connection; or tilt.



Photo 1



Photo 2

Performing a Bench Top Simulation Run

PC Setup

Make a folder called c:\TruIDL. Copy the TruIDL DashBoard to your Desktop and open it with Excel. Since there are macros in the DashBoard you may have to adjust your Macro security level to medium for them to function properly. Perform a 'Save As', select the file type as .xlt (2003) or .xltx (2007 & 2010) and let Excel save them in your default Template folder. Close Excel

Use TruIDL DashBoard

Open Excel, click on File/New and select the template you just created. You may have to select 'enable macros' first. Once the DashBoard is open you should be looking at the Instructions worksheet, if not, click 'Instructions' tab on the lower edge of the Excel window. After you have read the instructions, click on the 'Configure a Run' tab (TU5 shown below)

Parameter	Value	Description
Customer Name	UFS	Name of the Customer
Customer Location	Valpo	What is the city of the Customer's plant
E-Coat Tank Name	E-coat	What is the name of the E-coat tank where the test is being performed
Technician	F3	Your name
Test Date	3-Oct-2011	Date the test was conducted
Ware Description	short 9V batt	What is the P/N or description of the ware used in the Run
Run Label	Test 1	Why the test is being conducted (fill in with a free recall of this report)
Sample Rate	0.25	Sample Rate (0.062, 0.125, 0.250, 0.500, 0.750, 1.000, 2.000, 4.000)
Smoothing Number	1	Number of Samples in a Running Average (1, 4, 8 or 16)
Shutdown Timer	1	Duration in Minutes (0-2000) of no activity before turning off.
Voltage Sensor #1 Label	Sensor #1	Select a location for Voltage Sensor #1
Voltage Sensor #2 Label	Sensor #2	Select a location for Voltage Sensor #2
Voltage Sensor #3 Label	Sensor #3	Select a location for Voltage Sensor #3
Voltage Sensor #4 Label	Sensor #4	Select a location for Voltage Sensor #4
Voltage Sensor #5 Label	Sensor #5	Select a location for Voltage Sensor #5
Zone 1 Voltage	10	Voltage (1 - 500) used in Zone 1
Zone 1 Duration	30	Dwell Time in seconds (1 - 3000), Zone 1
Zone 2 Voltage	0	Voltage (0 - 500) used in Zone 2
Zone 2 Duration	0	Dwell Time in seconds (0 - 3000), Zone 2
Zone 3 Voltage	0	Voltage (0 - 500) used in Zone 3
Zone 3 Duration	0	Dwell Time in seconds (0 - 3000), Zone 3
Zone 4 Voltage	0	Voltage (0 - 500) used in Zone 4
Zone 4 Duration	0	Dwell Time in seconds (0 - 3000), Zone 4
Zone 5 Voltage	0	Voltage (0 - 500) used in Zone 5
Zone 5 Duration	0	Dwell Time in seconds (0 - 3000), Zone 5
Reset TruIDL Real Time Clock	No	Select Yes to update the Real Time Clock Calendar
Date	3-Oct-2011	Enter the new Day (01-09) 99 = 99th
Time	13:32	Enter the new time in 24 Hr format as HH:MM
TruIDL Module Serial Number		Enter the serial number of the TruIDL Logger
Sensor Harness Serial Number		Enter the serial number of the Sensor Harness

Make your selections in the yellow area. Use 1 second for the Sample rate and '1' for the Smoothing number. If you want, you can fill in 10 V for the Zone 1 voltage and 30 seconds for the Zone 1 duration. Save the Excel file with a unique name like '9 V battery test'

Click the button named 'Save Configuration Data'. Plug the USB cable from your PC to the Logger. Then upload c:\TruIDL\TRUIDL.TXT to the Logger. The text file should only be about 1 kB. You will have to click 'yes' to confirm the over-write since there was

a file existing with the same name.

Attach your Voltage sensor harness to the Module. Take the 9V Battery and the red and black battery clips. Connect the side of the leads to the top of the battery and observe the polarity. Next attach the black lead to the ground clamp of the Voltage Harness (green coiled wire). Wake the unit up with one tilt if it went to sleep. Then tilt it again to Arm it. Now the Green and Blue LEDs should be flashing once every 4 seconds. Place the red lead on the White sensor tip and hold for 5 seconds. Do you see just the Blue LED flashing every 4 seconds now? Move the red clip to brown, green, yellow, gray, (next 5 are for TU10 models only) orange, blue, red, black, and purple. Remove the red clip and wait 10 seconds. Afterwards the Green LED is On and the Amber is flashing every second or so, which means 'Successful Run'.

Now connect the USB cable to the PC and move the larger TRUIDL.TXT back over to c:\TruIDL folder. Click 'yes' to 'over-write the existing file with the same name'.

In the Excel file saved earlier, go to the View Data tab. Click the grey button 'Import Data from Run'. The Run data should show up in the columns as shown below (Model TU5). If you click on the Voltage tab you can see a graph has been prepared too.

