

# UFS Corporation Quickstart Installation Guide Power Supply

A. Choose a suitable location to mount the Power Supply Panel. UFSc recommends a location close to the Ed tank and below the rim. The panel should be mounted at a level that will make it accessible for maintenance.

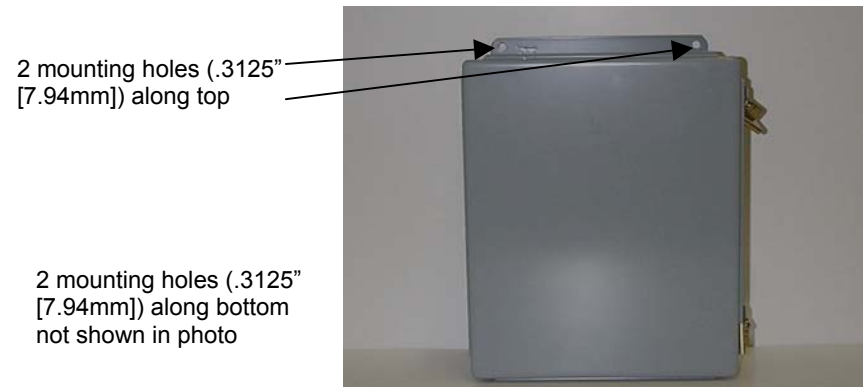

B. Size wire cable conduit for 120VAC 3 amp input/output power. The suggested entry is on the lower left side of the panel. The suggested exit is on the upper left side.

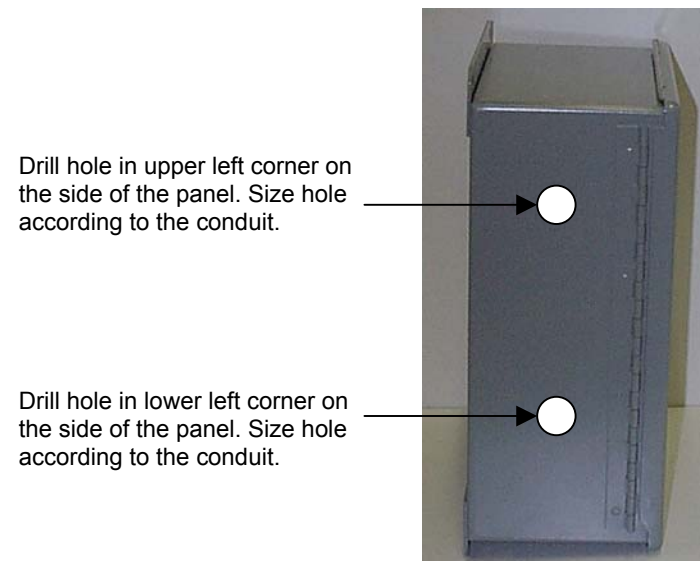

**Please read carefully before performing any work!**

C. Attach AC power source. Default = 120 VAC.

**Alternative AC Input Voltage\***

100:	terminals 1 and 5
220:	terminals 1 and 5
230/240:	terminals 1 and 4

*\* If any of these are used, wiring changes have to be made at the transformer.*

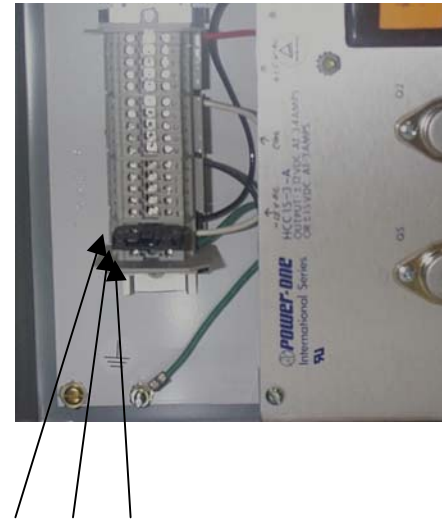

D. Connect accessories requiring 15 V DC to output terminals as shown in the wiring diagram located on the inside panel of the power supply.

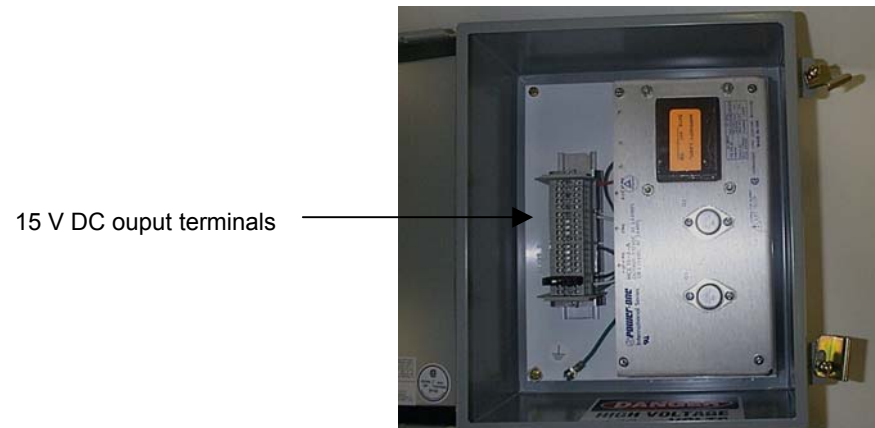

## Safety!

A safe work environment for our customers (their employees and outside contractors) is of utmost importance to UFS Corporation. All applicable OSHA and owner's safety requirements must be followed when performing any maintenance, inspection, and repair or testing on Electrodes and/or Electrode Systems. This includes, but is not limited to, the following safety regulations: Lockout/Tryout (Energy Control); Hazard Communication; Confined Spaces; Personal Protective Equipment; Electrical Safe Work Practices; Ergonomics and Material Handling; Accident Prevention signs (Danger – Energized Equipment).

Before installing or working on the DC rectifier, Lockout/Tryout procedures are to be followed. Continuous training of employees on ED equipment and system installation, operation, and maintenance of UFSc components is strongly recommended. MSDS (Material Safety Data Sheets) are provided for UFSc materials, and replacement or missing copies are available upon request from the UFSc Safety Coordinator.

**Refer to your Getting Started Package for more detailed information on your system. For further assistance contact UFSc Customer Service.**

